

# PORTABLE BACKDROP KIT INSTRUCTIONS

1. Remove screw from bottom of pin.
2. Push screw from bottom side through hole in center of baseplate.
3. Tighten pin clockwise back onto screw with baseplate in between. Repeat with second base plate and place them the required width apart.
4. Slide (unslotted) bottom half of upright onto pin. Join upper half of upright post (piece with slots at top) with the unslotted bottom piece. Repeat with second upright.
5. The adjustable drape support rod is made up of 3 pieces; 2 end pieces (each have a hook) and a middle piece (with 4 button holes). One of the end pieces is stored inside the middle piece. Pull this towards the hook side until the last button engages.
6. Snap the other endpiece into the other end of the middle piece. The width is adjustable by disengaging these buttons.
7. Thread drapes onto adjustable drape support rod.
8. Place hook on one end of drape support rod snugly into upright slot.
9. Repeat with the other end of drape support rod on second upright.

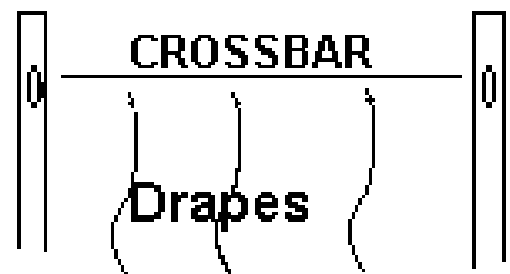
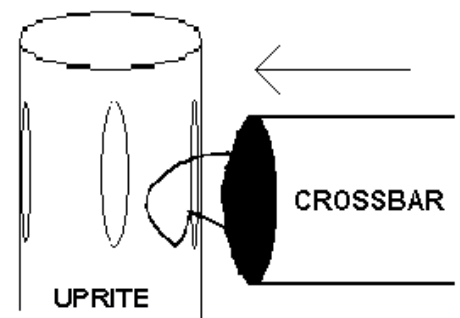
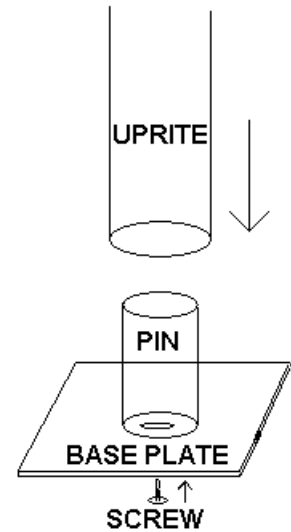

**OnlineEEL.com**

Event Decorating Products International Store

# PORTABLE BACKDROP KIT PARTS LIST

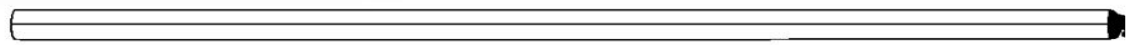
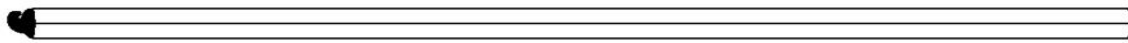
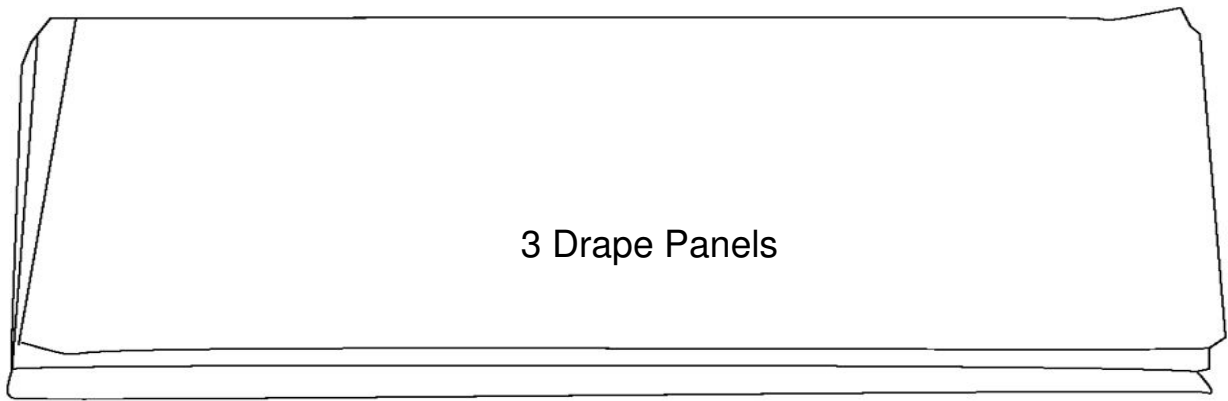

3 piece Drape Support Rod ("crossbar")

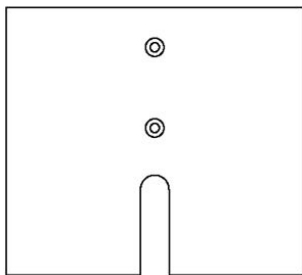

2 Base Plates

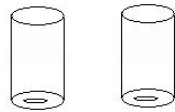

2 Base Plate Pins

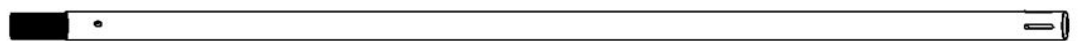
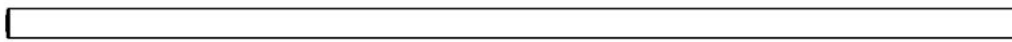
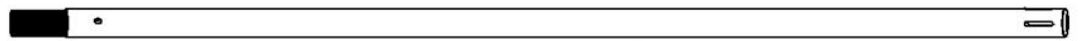
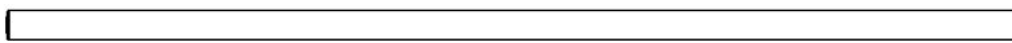
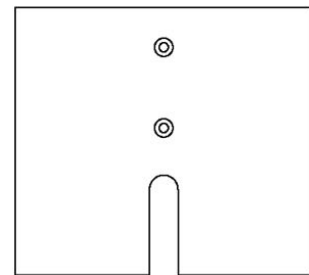

2 Break Apart Uprights

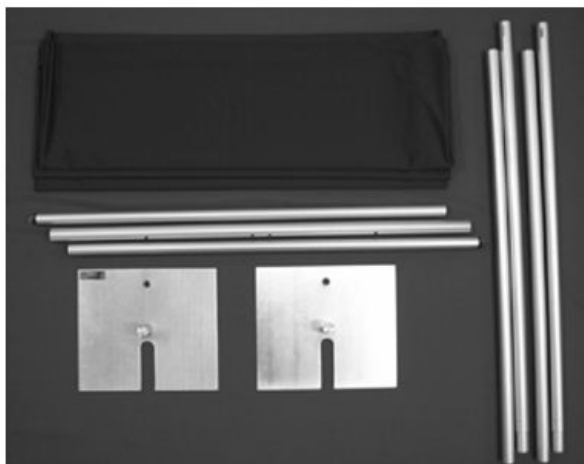

**OnlineEEL.com**  
Event Decorating Products  
International Store